

# Hand Winches AMS Spark-Proof series



## Technical description

The Winches to be used in Hazardous areas must be on the spark-proof type.

- Galvanized wire rope
- Bronze ratchet wheel

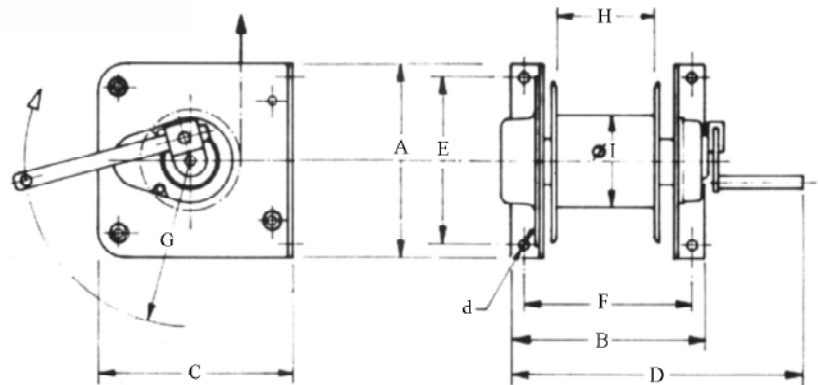
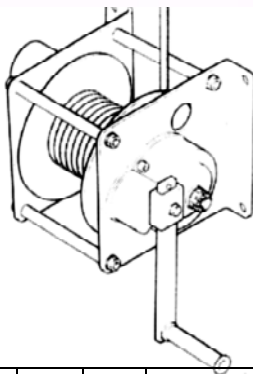
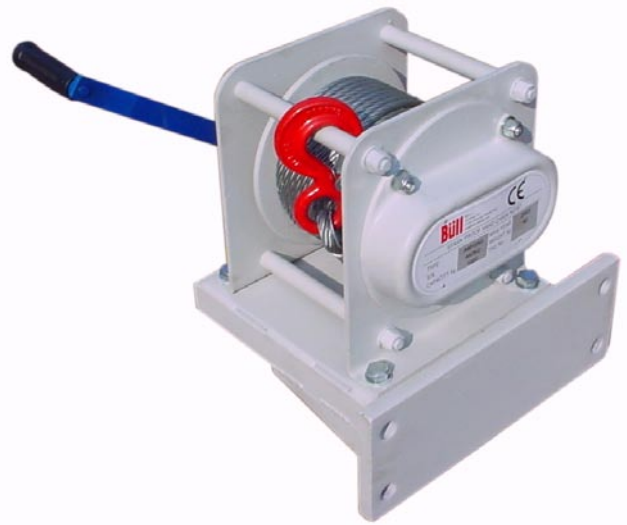

Capacity Kg	Type	Test load Kg	Rope mm	Max winding up m   layers	Handle turns for m 1 hoisting n.	Average effort on handle Kg	diam. Drum mm	OVERALL DIMENSION mm										Weight without rope Kg
								A	B	C	D	E	F	G	H	diam. d		

100	001-AMS	120	3	22	6	5	18	48	145	134	115	248	125	114	200	58	8,5	4
250	002-AMS	300	5	22	7	44	9	65	160	145	160	260	140	125	200	52	8,5	6
600	006-AMS	720	8	18,5	4	56	10	88	170	200	180	315	150	180	200	108	8,5	9
1000	010-AMS	1200	9	35	4	84	10	138	290	300	295	480	250	260	250	150	18	25
1500	015-AMS	1800	11	27	3	65	16	190	290	300	295	480	250	260	300	150	18	30
2000	020-AMS	2400	12	25	3	64	20	190	290	300	295	480	250	260	300	150	18	30